

Spare parts ACTUSMART CM03

1 Standard version

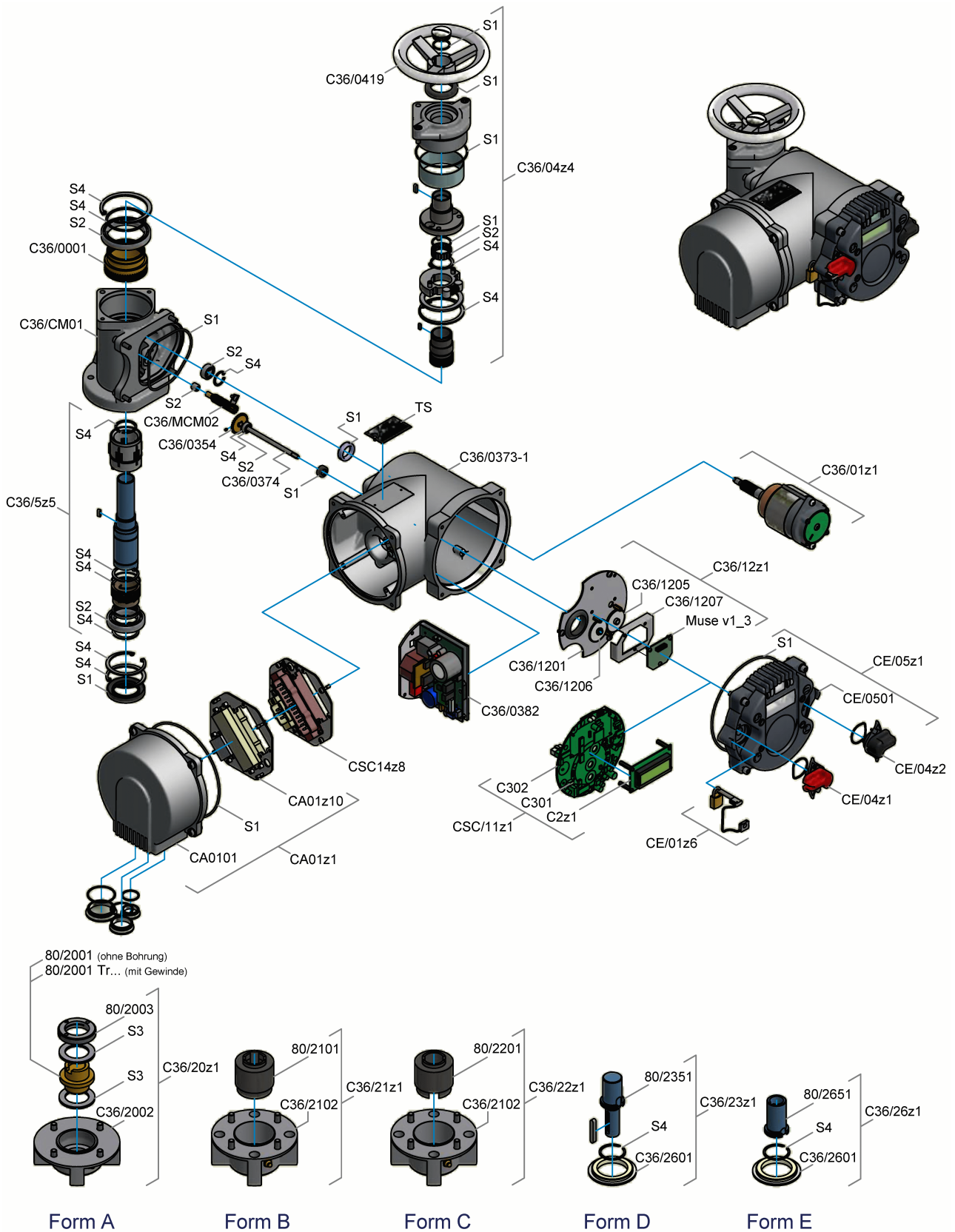

2 Explosion-proof version

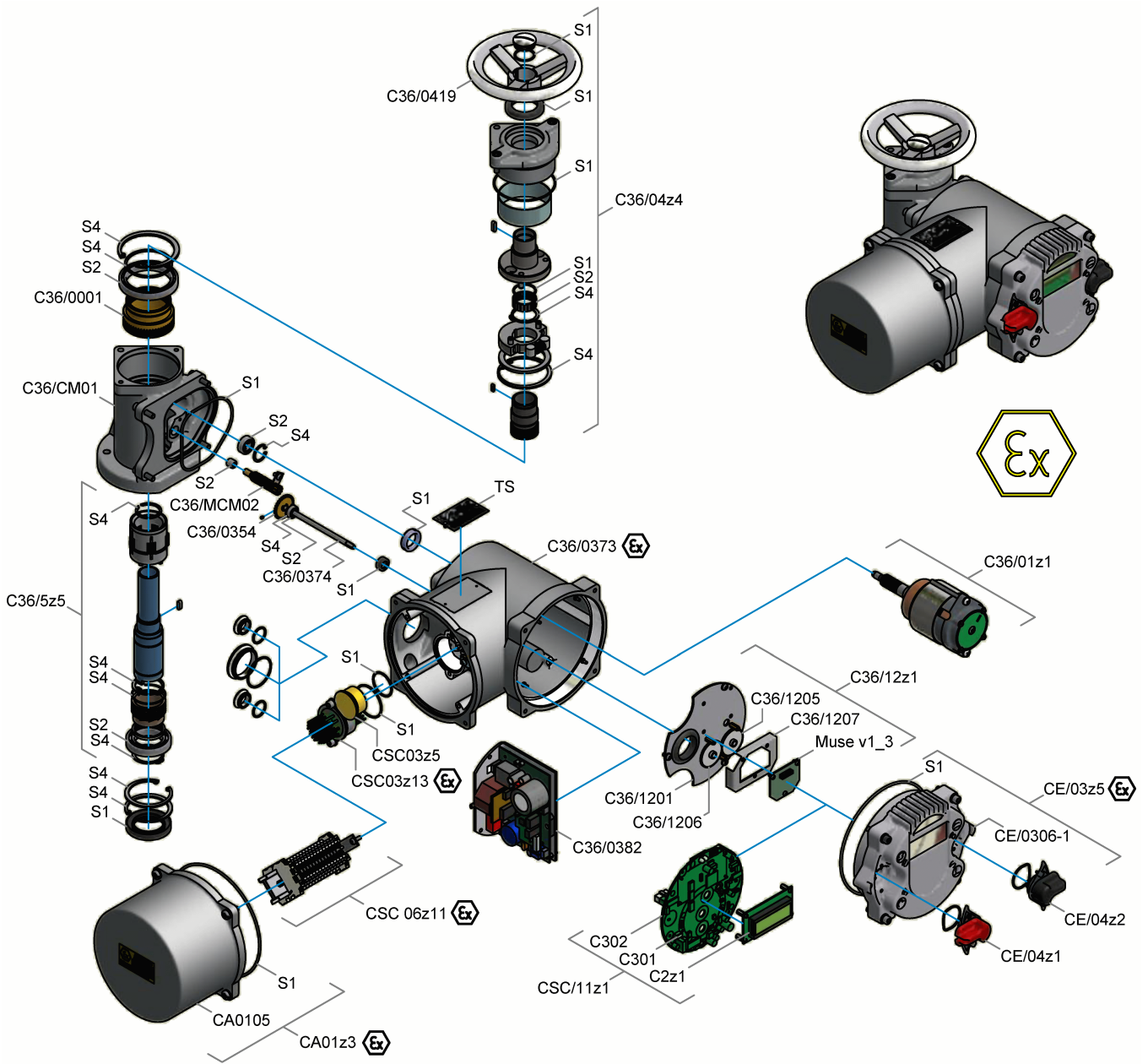

80/2001 (ohne Bohrung)
80/2001 Tr... (mit Gewinde)

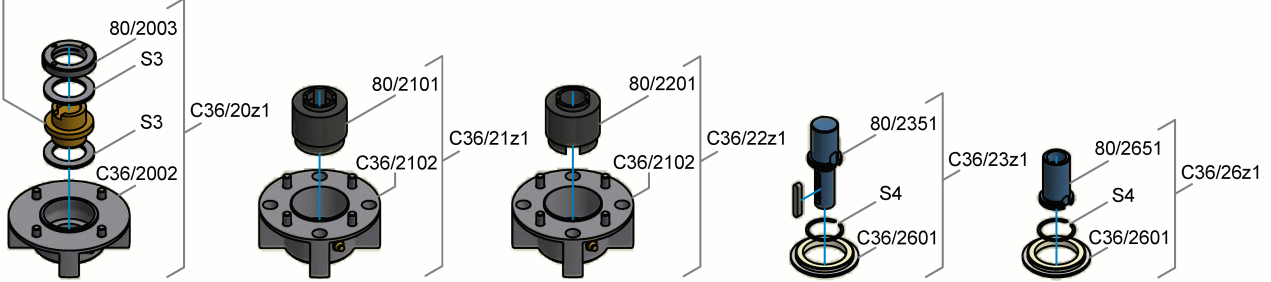

Form A

Form B

Form C

Form D

Form E

No.	Description
CA01z1	Assembly A-cover
CA0101	A-cover
CA01z3	Terminal box assembly
CA0105	Lid of terminal box
CA01z10	Assembly insertable plate A-cover-side
C36/CM01	Housing CM03
C36/MCM02	Helical pinion
C36/0001	Worm-wheel 1GG
CSC14z8	Assembly insertable plate CM drive side
CSC06z11	Terminal assembly
CSC03z13	Cable bushing LD44 assembly
CSC03z5	Dummy bushing LD34 assembly
C36/01z1	Motor assembly
C36/0382	Inverter assembly
C36/12z1	Multiturnsensor assembly
Muse V1.3	Multiturnsensor Print
C36/1201	Schott CM03
C36/1205	Sensorgear CM z72
C36/1206	Sensorgear CM z70
C36/1207	protection cover for sensor
C36/0374	Sensor shaft CM03
CSC 11z1	Logic module
C2z1	Display
C304	Profibus board (not visible)
C302	Fuse
C301	Ligic board
CE 05z1	E-cover assembly CM
CE04z1	Red switch assembly
CE04z2	Black switch assembly

No.	Description
CE 0501	E-cover CM
CE05z5	E-cover assembly CM in Ex-version
CE0601-1	E-cover CM in Ex-version
CE 01z6	Locking pin assembly
C36/0354	Gear m1z30
C36/0373-1	Housing-E CM03
C36/04z4	Handwheel CM03 assembly
C36/0419	Handwheel CM03
C36/05z5	Spindle CM03 assembly
C36/20z1	Output type "A" und "Am" assembly
C36/2002	Flange type "A" and "Am"
80/2001	Spindle nut
80/2003	Ring nut
C36/21z1	Output type "B" assembly
C36/2102	Flange type "B" and "C"
80/2101	Socket "B"
C36/22z1	Output type "C" assembly
80/2201	Claw coupling "C"
C36/23z1	Output type "D" assembly
80/2351	Output shaft "D"
C36/2601	Centring ring F07
C36/26z1	Output type "E" assembly
80/2651	Output shaft "E"
S1	Sealing set
S2	Bearing set
S3	Axial bearing set
S4	Safety ring set

CAUTION: When ordering spare parts, please provide the drive or device type and serial number (see type label). Use only original spare parts supplied by SCHIEBEL. Using other parts will render the warranty void. Illustrations may differ from actual spare parts.

